

Age Range: 3 and up
 Weight Limit: 65 LBS
 Surfaces: Grass/Asphalt & Other
 Hard Surfaces
 Speed: 2.5 MPH For/Rev
 5.0 MPH For
 Colors: Black Body/Silver Seat
 Black Wheels



C7478

Kawasaki ATV

Advanced Series 12V
 Wal-Mart Exclusive

Intro: 2004
 Suggested Retail: 169.99
 Box Dimensions:
 19.25 x 24.875 x 41
 51 lbs.
 Warranty
 One Year Vehicle

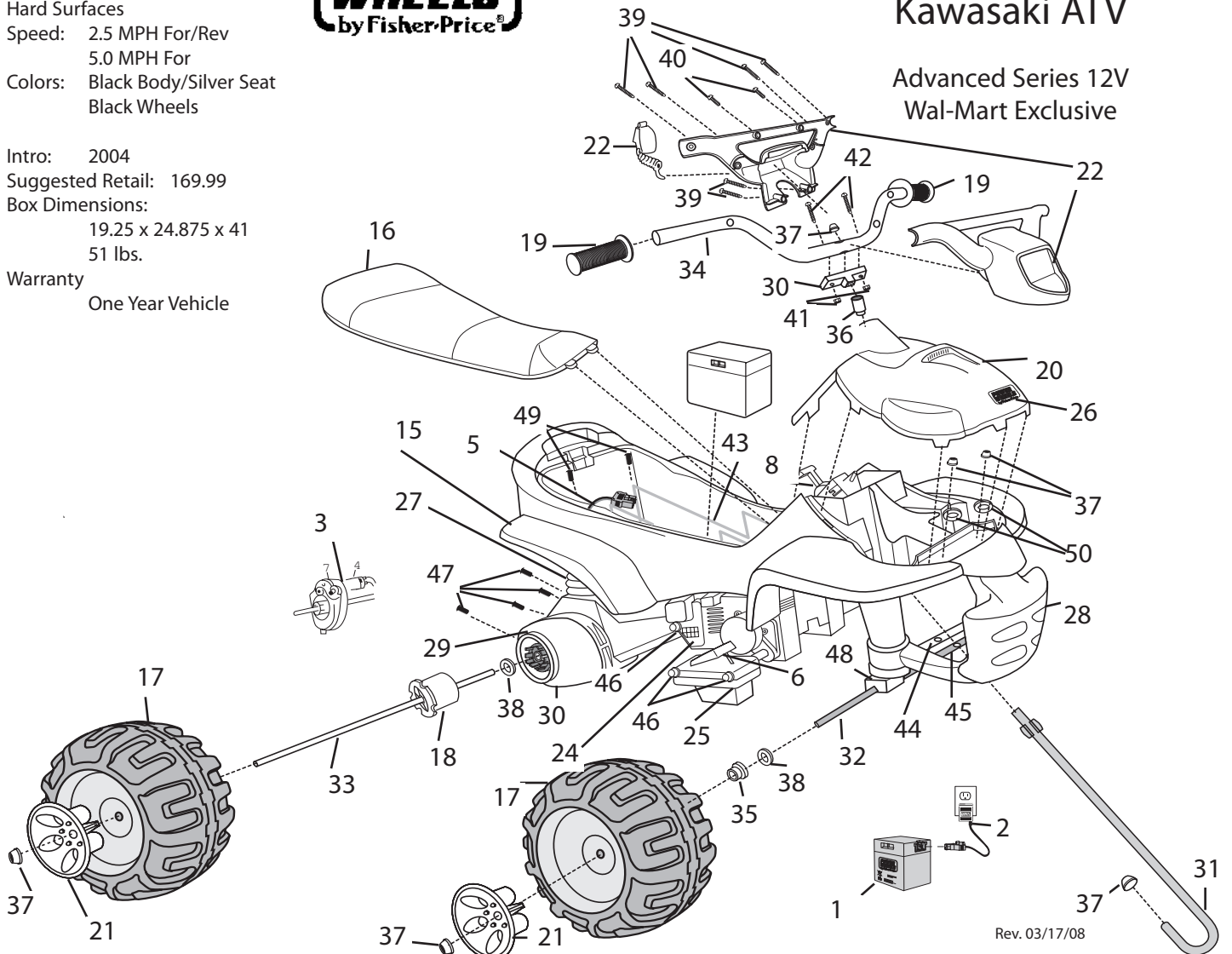

Rev. 03/17/08

Item No.	Description	Part No.	Qty.	Item No.	Description	Part No.	Qty.	Item No.	Description	Part No.	Qty.
Working / Electrical Parts				Hardware / Metal Parts				Parts Not Shown			
1.	12V Battery	00801-0638	1	30.	Handlebar Neck	73690-4289	1	50.	Top Bushing	74110-2129	2
2.	12V Charger w/Probe	00801-0972	1	31.	*Steering Column	73690-4249	1	51.	Trusshead Screw	0801-0278	1
3.	Motor Gearbox Assembly	00968-2912	2	32.	Front Axle	73690-4509	2	Large Parts Bag C7478-9249 1			
4.	Motor Pinion Assembly	0968-2702	2	33.	Rear Axle	73690-4549	1	Small Parts Bag N/A C7478-9259 1			
5.	Main Harness Assembly	C7478-9799	1	34.	Handlebar	74282-4219	1	Hardware Bag C7478-9279 1			
6.	Footboard Assembly	73690-9169	1	35.	Round Bushing	74550-2689	2	Owner's Manual C7478-0920 1			
7.	Gearbox W/out Motor	00968-2802	2	36.	Steering Bushing	78476-2259	1	Decal Sheet C7478-0310 1			
8.	Shifter Assembly	73690-9439	1	37.	*.437 Cap Nut	0801-0226	6	Cap Nut Tool 78640-2629 1			
Plastic / Other Parts				38.	7/16" Washer	0801-0196	4	Adhesive Clip (Harness) 0801-0313 2			
15.	Body	N/A	1	39.	# 6 x 1" Screw (Order Hardware Bag)	00912-6006	6	False Motor Cover Left 73690-2069 1			
16.	Seat	C7478-2309	1	40.	# 6 x 1/2" Screw	00912-6002	2	Footrest 73690-2189 1			
17.	Wheel	73690-2469	4	41.	# 10-32 Lock Nut N/A (Order Hardware Bag)	0801-0318	3	Footboard Support (Metal) N/A 76262-4439 1			
18.	Rear Wheel Driver	74460-2249	2	42.	# 10 x 1 5/8" Screw (Order Hardware Bag)	N/A	2	Motor Rod Lower (no sub) 74110-4569 1			
19.	Handgrip	74527-2229	2	43.	Battery Retainer	74110-4429	1	Shifter w/Harness 73690-9679D 1			
20.	Cowling	3800-7368	1	44.	Crossbar	73690-4649	1	Footswitch (plunger-type) 00801-1566 1			
21.	Hubcap	73690-2579	4	45.	Steering Linkage Assembly	B2008-9239	1				
22.	Handlebar Assy. W/Microphone	3800-7474	1	46.	.354 Retainer	0801-0604	4				
24.	False Motor Cover Right	73690-2059	1	47.	#8-18 x 3/4 Screw	0801-0223	10				
25.	Footboard -Lower	73690-2179	1	48.	Bottom Bushing	74110-2639	2				
26.	PW Emblem	74460-9069	1	49.	#10 x 1.25" N/A	00801-0260	2				
27.	Rear Shock Boot	74527-2089	2								
28.	Brushguard	73690-2079	1								
29.	Motor Housing Top	C7478-2159	1								
30.	Motor Housing Bottom	C7478-2169	1								

N/A = Not Available

*Service Bulletin 174

Bold and Underlined parts are to be purchased and installed by Service Centers only. These items may not be sold directly to consumers by Service Centers or Fisher-Price.